

Omnipod DASH™ Insulin Management System

PODDER™ QUICK GLANCE GUIDE

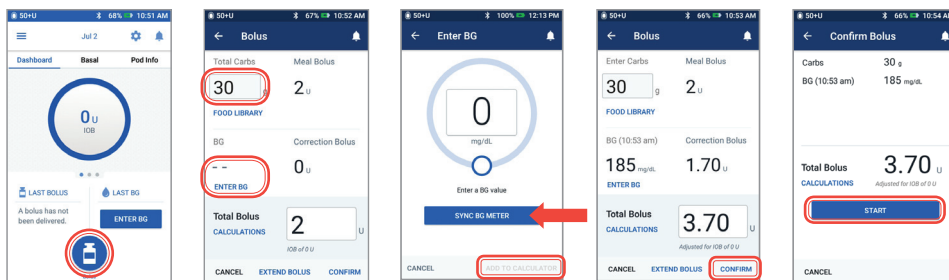

HOW TO DELIVER A BOLUS



1. + Tap the Bolus button on the Home screen
2. + Enter grams of carbs (if eating) + Tap "ENTER BG"
3. + Tap "SYNC BG METER", or enter BG manually + Tap "ADD TO CALCULATOR"
4. + Tap "CONFIRM" once you have reviewed your entered values
5. + Tap "START" to begin bolus delivery

*From CONTOUR®NEXT ONE BG Meter

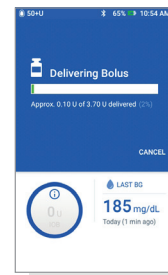

Reminder

The Home screen displays a progress bar and details while you are delivering an immediate bolus. You cannot use your PDM during an immediate bolus.

HOW TO SET A TEMP BASAL

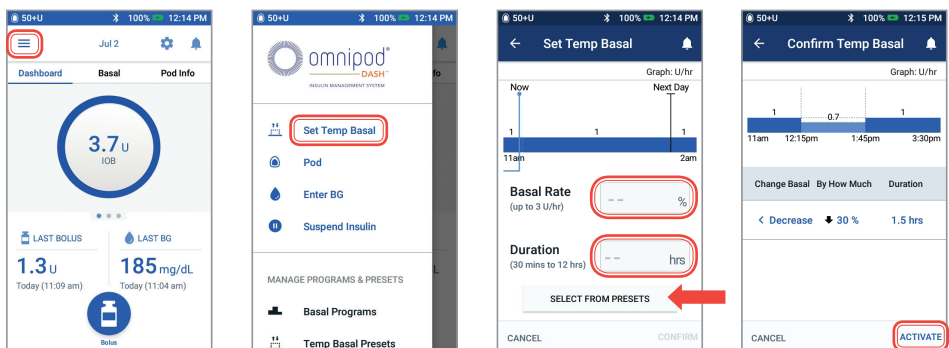

1. + Tap Menu icon on the Home screen
2. + Tap "Set Temp Basal"
3. + Tap Basal Rate entry box and select your % change + Tap Duration entry box and select your time duration + Or tap "SELECT FROM PRESETS" (if you have saved Presets)
4. + Tap "ACTIVATE" once you have reviewed your entered values

Did you know?

- Temp Basal is highlighted in green if there is an active temp basal rate running
- You can swipe to the right on any green confirmation message to dismiss it sooner

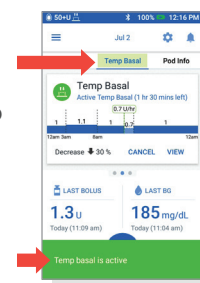

SUSPEND AND RESUME INSULIN DELIVERY

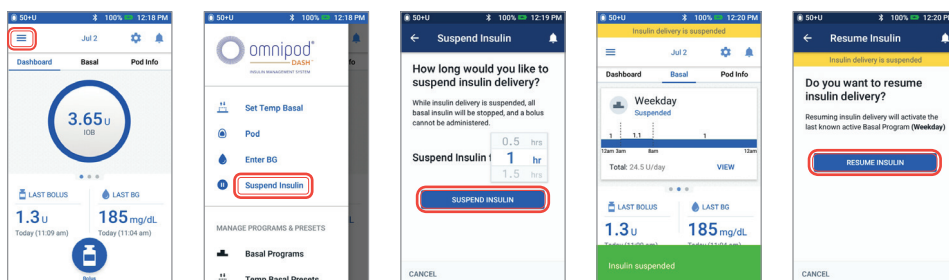

1. + Tap Menu icon on the Home screen
2. + Tap "Suspend Insulin"
3. + Scroll to desired duration of insulin suspension + Tap "SUSPEND INSULIN" + Tap "Yes" to confirm you want to stop insulin delivery
4. + The Home screen displays a yellow banner stating insulin is suspended
5. + Tap "RESUME INSULIN" to start insulin delivery

Reminder

- You **MUST** resume insulin, insulin does not automatically resume at end of suspension period
- The Pod beeps every 15 minutes throughout the suspension period to remind you that insulin is not being delivered
- Your temp basal rates or extended boluses are canceled when insulin delivery suspends

Omnipod DASH™ Insulin Management System

PODDER™ QUICK GLANCE GUIDE



HOW TO CHANGE A POD

1. + Tap "Pod Info" on the Home screen
+ Tap "VIEW POD DETAILS"
2. + Tap "CHANGE POD"
+ Carefully follow the on-screen directions
+ Pod will be deactivated
3. + Tap "SET UP NEW POD"
4. + Carefully follow the on-screen directions

Don't forget!

- Keep the Pod in plastic tray during fill and prime
- Place the Pod and PDM next to each other and touching during priming
- A Check BG reminder alerts you to check your blood glucose level and infusion site 90 minutes after Pod activation

For more detailed instructions refer to the Omnipod DASH™ Insulin Management System User Guide

HOW TO VIEW INSULIN AND BG HISTORY

1. + Tap Menu icon on the Home screen
2. + Tap "History" to expand list
+ Tap "Insulin & BG History"
3. + Tap the day drop-down arrow to view 1 day or multiple days
4. + Continue swiping up to see the details section
+ Tap the down arrow to display more details

History at your fingertips!

- BG info:
 - Average BG
 - BG in Range
 - BGs Above and Below range
 - Average Readings per day
 - Total BGs (in that day or date range)
 - Highest and Lowest BG
- Insulin info:
 - Total Insulin
 - Avg Total Insulin (for date range)
 - Basal Insulin
 - Bolus Insulin
 - Total Carbs
- PDM or Pod events:
 - Extended Bolus
 - Activation/reactivation of a Basal program
 - Start/end/cancellation of a Temp Basal
 - Pod activation and deactivation

This Podder™ Quick Glance Guide is intended to be used in conjunction with your Diabetes Management Plan, input from your healthcare provider, and the Omnipod DASH™ Insulin Management System User Guide. Personal Diabetes Manager imagery is for illustrative purposes only and should not be considered suggestions for user settings. Refer to the Omnipod DASH™ Insulin Management System User Guide for complete information on how to use the Omnipod DASH™ System, and for all related warnings and cautions. The Omnipod DASH™ Insulin Management System User Guide is available online at myomnipod.com or by calling Customer Care (24 hours/7 days), at 800-591-3455. This Podder™ Quick Glance Guide is for Personal Diabetes Manager model PDM-USA1-D001-MG-USA1. The Personal Diabetes Manager model number is written on the back cover of each Personal Diabetes Manager.